



- ▶ WEBAC® 5620 is a low viscosity 1C liquid bituminous emulsion for priming dry or slightly damp mineral substrates. WEBAC® 5623 is a plastic-modified bituminous thick coating for sealing structural elements with ground contact against pressing water (W2.1-E).

Range of application

WEBAC® 5620

- Primer for bituminous thick coatings

WEBAC® 5623

- Plastic-modified for sealing structures with ground contact according to DIN 18533-3 and EN 15814:2011 + A2:2014 (CE-Declaration of Performance/3)
- Sealing of basements, underground parking garages, wet rooms and retaining walls
- Adhesive for insulation, protection and drainage boards

WEBAC-Chemie GmbH
Fahrenberg 22
22885 Barsbüttel
Germany
Tel. +49 40 67057-0
Fax +49 40 6703227
info@webac.de

www.webac.de

Properties

WEBAC® 5620

- Water dilutable

WEBAC® 5623

- Fiber-reinforced
- Good crack-bridging properties
- Environmentally friendly
- Quickly curing and rain-proof
- High stability

Example

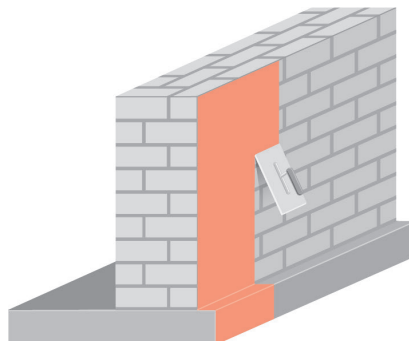

Sealing structures with ground contact

▶ Technical Information

All the data indicated in this technical data sheet and any related information provided by our employees are of an advisory nature representing our current state of knowledge and in no way binding. As the exact chemical, technical and physical conditions of the actual application are beyond WEBAC's control, this information does not preclude examination of the products and/or procedures for the intended application and surface by the user. WEBAC is thus unable to guarantee results. The user is fully responsible for the observation of existing regulations and conditions when using the products. © WEBAC-Chemie GmbH. Version 03/2020

Surface Sealings

WEBAC® 5620/5623 CE

WEBAC®

| Technical data WEBAC. 5620 | Values |
|------------------------------------|------------|
| Density, 20 °C / 68 °F (EN 52 004) | ≈ 1.0 kg/l |
| Solids content | > 30% |

The specified data are values determined under laboratory conditions and are subject to a certain fluctuation. Deviations are possible in practice depending on the respective object situation.

| Technical data WEBAC. 5623 | Values |
|--|---|
| Mixing ratio | 22 : 8 parts by weight |
| Density of mixture | ≈ 1.1 kg/l |
| Application temperature | 5 – 30 °C / 41 – 86 °F |
| Pot life* | min. 1 – 2 h |
| PH-value | 10 – 13 |
| Resistance to rain* | after ≈ 4 h |
| Full curing* | 1 – 2 d |
| Crack bridging ability | Class CB2 |
| Compressive strength | Class C2A |
| Watertightness | Class W2A |
| Fire behavior (EN 13501-1) | Class E |
| CE classification (DIN EN 15814:2011 + A2:2014) | PMB-W2A, CB2, C2A |
| EPD | EPD-DBC-2013211-D |
| Exposure scenarios according to REACH | Assessment of industry standard application |

* depending on air moisture, temperature, layer thickness and surface

The specified data are values determined under laboratory conditions and are subject to a certain fluctuation. Deviations are possible in practice depending on the respective object situation.

WEBAC-Chemie GmbH
Fahrenberg 22
22885 Barsbüttel
Germany
Tel. +49 40 67057-0
Fax +49 40 6703227
info@webac.de

www.webac.de

Technical Information

All the data indicated in this technical data sheet and any related information provided by our employees are of an advisory nature representing our current state of knowledge and in no way binding. As the exact chemical, technical and physical conditions of the actual application are beyond WEBAC's control, this information does not preclude examination of the products and/or procedures for the intended application and surface by the user. WEBAC is thus unable to guarantee results. The user is fully responsible for the observation of existing regulations and conditions when using the products. © WEBAC-Chemie GmbH. Version 03/2020

Surface Sealings

WEBAC® 5620/5623 CE



Preparatory work

Structural analysis:

- Nature of the substrate
- Structural conditions (temperature and air moisture)
- Water load classes
- Existing surface interruptions due to fitted structures (e.g. pipe ducts)

Pretreatment of the substrate:

- The pretreatment of the substrate must always be carried out in accordance with DIN 18533 Part 3
- Substrates must be free of loose and separative substances
- Pretreat substrate to obtain a closed, smooth surface of good grip
- Existing, well-adhering bituminous coatings can be reworked after cleaning
- An installation finish must be applied on concrete substrates before applying the bituminous thick coating; the coating material itself can be used as installation finish
- Mineral substrates must be primed with undercoat **WEBAC® 5620**



Mixing

WEBAC® 5620

- Ready to use, stir material thoroughly

WEBAC® 5623

- Briefly stir component A (liquid), e.g. with a slow running anchor stirrer
- Add component B (powder) to the container of component A and mix homogenously



Application instruction

- Protect from mechanical stress (e.g. by perimeter insulation)
- Only use pure WEBAC material without any residues of cleaning agents or other impurity



Application

WEBAC® 5620

- Apply to substrate by smoothing trowel or trowel
- Air moisture and light influence the curing speed

WEBAC® 5623

- Apply at the respectively required layer thickness by smoothing trowel or trowel in at least two operations
- The second layer can be applied as soon as the first layer has dried and cannot be damaged
- Embed reinforcement fabric where required according to DIN 18533, part 3
- Air moisture and light influence the curing speed

For further information on the use of bituminous coatings, refer to the current standards!



Cleaning

- Clean the equipment with water
- Remove cured residues with white spirit (**WEBAC® 5620**)

WEBAC-Chemie GmbH
Fahrenberg 22
22885 Barsbüttel
Germany
Tel. +49 40 67057-0
Fax +49 40 6703227
info@webac.de

www.webac.de

Surface Sealings

WEBAC® 5620/5623 CE

| Product data | WEBAC® 5620 | WEBAC® 5623 |
|----------------------|---|---------------------------------|
| Application | • By brush or wide brush | • By smoothing trowel or trowel |
| Packing | Unit 10 l | Unit 30 kg |
| Material consumption | ≈ 0.1–0.3 kg/m ² | |
| Storage | <ul style="list-style-type: none"> • Between 5 °C / 41 °F and 30 °C / 86 °F • Protect from frost • Protect from moisture, heat and light • In original, sealed containers | |

WEBAC-Chemie GmbH
 Fahrenberg 22
 22885 Barsbüttel
 Germany
 Tel. +49 40 67057-0
 Fax +49 40 6703227
 info@webac.de

www.webac.de

| Water impact classes | Values | |
|--|---|--|
| | Layer thickness in mm (≈) dry • wet | Consumption per m ² (≈) |
| Scratch primer | – | 1–2 kg |
| W1-E (soil moisture and non-pressing water) | 3.0 • 3.9 | 4.3 kg |
| W2.1-E (moderate impact of pressing water ≤ 3 m insertion depth) | 4.0 • 5.2 | 5.8 kg |
| W3-E (non-pressing water on structures covered with earth) | 4.0 • 5.2 | 5.8 kg |
| W4-E (splash water and soil moisture on wall bases) | 3.0 • 3.9 | 4.3 kg |
| Installation of polystyrene sheets | – | 1–2 kg |

The specified data are values determined under laboratory conditions and are subject to a certain fluctuation. Deviations are possible in practice depending on the respective object situation.

Test certificate

- Declaration of performance according to Construction Products Regulation

Occupational safety/waste disposal

- ▶ Downloads on webac-grouts.com



[webac-grouts.com/
downloads](http://webac-grouts.com/downloads)

▶ Technical Information

All the data indicated in this technical data sheet and any related information provided by our employees are of an advisory nature representing our current state of knowledge and in no way binding. As the exact chemical, technical and physical conditions of the actual application are beyond WEBAC's control, this information does not preclude examination of the products and/or procedures for the intended application and surface by the user. WEBAC is thus unable to guarantee results. The user is fully responsible for the observation of existing regulations and conditions when using the products.
 © WEBAC-Chemie GmbH. Version 03/2020