

A collection of various industrial hoses and fittings. The items include several orange braided hoses with black markings, a grey braided hose, a red solid hose, and a black solid hose. There are also blue and yellow hoses. Various connectors, valves, and fittings are scattered throughout, including red and white plastic fittings, metal connectors, and a red ring. The hoses are arranged in a circular pattern on a white background.

SPECIAL
CONSTRUCTION
PRODUCTS



Content

Cartidge Systems

WEBAC® QuickSet	2
-----------------------	---

Injection Silane

WEBAC® 2130	4
-------------------	---

Cleaner

WEBAC® Degreasing Agent	5
-------------------------------	---

Injection Tubes

WEBAC® Injection Tube AB/Type 2	6
Accessories	6
Installation	7

Swelling Tapes

WEBAC® Bentonite Swelling Tape	8
WEBAC® Polymer Swelling Tape	9
Accessories	10
Installation	11
WEBAC® Swelling Paste	12

Tie Point Sealing

WEBAC® Plug/Ring/Flange	13
-------------------------------	----

WEBAC® Injection Packers

14

Joint Repairs

WEBAC® Sealing Tape XT	16
Installation	17
WEBAC® Impact Profiles EPDM	18
WEBAC® Compression Profiles	19

NOTE

Please observe all existing regulations and the instructions in the technical data sheets on the respective WEBAC products.

We will be glad to help you find solutions to individual problems.

All the data given in this brochure are of an informative nature representing our current state of knowledge and are in no way binding. Any information regarding this brochure given by our employees is likewise non-binding. As the exact chemical, technical and physical conditions of the actual application are unknown to WEBAC, this information does not preclude examination of the products and procedures for the intended application by the user. WEBAC is thus unable

to guarantee results. The user is fully responsible for the observation of existing regulations and requirements when using the products. With the publication of this brochure all previous versions are no longer valid. Copyright by WEBAC-Chemie GmbH. Reproduction and/or printing of extracts from this brochure is permitted only with the prior consent of WEBAC-Chemie GmbH. Version 05/19

Cartridge Systems

WEBAC® QuickSet



WEBAC® QuickSet is a 2C cartridge system designed for smallscale injections which shall be carried out quickly and safely. **WEBAC® 150**, **WEBAC® 1500** and **WEBAC® PURseal M S** present their proven material properties also in cartridges. WEBAC cartridge products are ready for use immediately using the innovative **WEBAC® QuickSet Pump**.

Advantages of cartridge application

- Easy and safe – ready for use immediately
- User-friendly
- High dosing accuracy, no mixing errors
- Economical consumption
- Clean procedure, no cleaning effort

WEBAC® 150

- Fast and highly expanding foam
- Foam structure not too rigid
- Mixing ratio: 1 : 1 parts by volume
- Packing: 6 x 400 ml

WEBAC® 1500

- Fast curing with and without water
- Fast sealing foam structure upon contact with water (pressing water)
- Low viscosity
- Elastic foam structure
- Permanent sealing
- Mixing ratio: 1 : 1 parts by volume
- Packing: 6 x 400 ml

WEBAC® PURseal M S

- General Technical Approval on environmental soundness
- Cures without water contact to form a pore-free, compact and high strength material
- Slight foam formation upon water contact
- Fast curing – durable sealing
- Mixing ratio: 1 : 1 parts by volume
- Packing: 6 x 400 ml

For more detailed information on the products, please see the technical data sheets of WEBAC® 150/1500/PURseal M S.



WEBAC® QuickSet Pump €€

Mixing ratio: 1 : 1 / 2 : 1

Max. air inlet pressure: 8 bar

Max. operating pressure: 6 bar

Max. cartridge content: 400 ml

Weight: ≈ 2.4 kg

For information on the operation, please see the WEBAC manual.

WEBAC® QuickSet Packers

Dimensions: ø 12 mm, length 77 mm

Connection: quick coupling system

Valve: freewheeling ball

Max. injection pressure: ≈ 50 bar

Material: plastic

WEBAC® QuickSet Pump, manual



Mixing ratio: 1 : 1 / 2 : 1

Operation: manual

Pressure ratio: 35 : 1

Max. cartridge content: 400 ml

Weight: ≈ 1.5 kg

Injection Silane

WEBAC® 2130



Range of application

- Damp proof course (dpc) in masonry up to a degree of 95% moisture penetration

Special properties

- Easy and reliable application
- Easy-dose product
- Causes no darkening of color or stain formation on the building materials

Instructions for use

- Pressureless injection by gun
- Injection by 1C pump

Technical parameters

Density, 20 °C / 68 °F: $\approx 0.8 \text{ g/cm}^3$

Application temperature: 5 °C – 25 °C / 41 °F – 77 °F

Kinematic viscosity, 21 °C / 70 °F: $> 20.5 \text{ mm}^2/\text{s}$

Drill hole diameter: 12 mm

Drill hole spacing: 10 – 12.5 cm

Material consumption:
100 ml/running meter/10 cm wall thickness

The specified data are values determined under laboratory conditions and are subject to a certain fluctuation. Deviations are possible in practice depending on the respective object situation.

Cleaner

WEBAC® Degreasing Agent



Range of application

- Cleaning of concrete or masonry surfaces by removing:
 - Major or stubborn impurities caused by:
 - mold release oil and other (industrial) oils
 - greases and oils, e.g. used in gastronomy or the food sector
 - Salinization, e.g. occurring in building structures used in farming operations
 - Acidified substrates

Special properties

- Extremely good penetration
- Deep down cleaning action
- Easy to rinse with water

Instruction for use

- Brush in/rinse/suck off

Technical parameters

Density, 20 °C / 68 °F (ISO 2811): $\approx 1.0 \text{ g/cm}^3$

Viscosity (ISO 3219): $\approx 30 \text{ mPas}$

Application temperature: $> 5 \text{ °C} / 41 \text{ °F}$

The specified data are values determined under laboratory conditions and are subject to a certain fluctuation. Deviations are possible in practice depending on the respective object situation.

WEBAC® Injection Tubes AB/Type 2



Range of application

- Sealing of construction joints in concrete construction (National Test Certificate)
- Structural or elastic installation of concrete building elements
- Additional sealing of joint tapes or joint plates

Special properties

- Easier and quicker installation at all levels and angles
- Minimum injection resin consumption thanks to optimal tube dimensioning



WEBAC® Injection Tube AB



Perforated plastic tube

Ø internal: 6 mm, Ø external: 12 mm

National Test Certificate in combination with WEBAC® 1403P and WEBAC® 1405

WEBAC® Injection Tube Type 2



Perforated tube with double fabric membrane

Ø internal: 6 mm, Ø external: 12 mm

National Test Certificate in combination with WEBAC® 1405

Accessories

Injection- and ventilation adapter	Clamp for fastening to waterbars and waterstops
Shuttering packer K	Plug-in clamp
Tube connector	Cone screw
Fastening grid	Clamp without/with hole

Installation

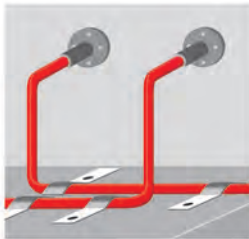
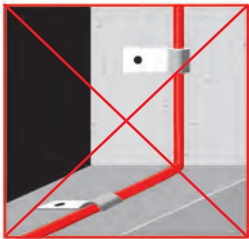
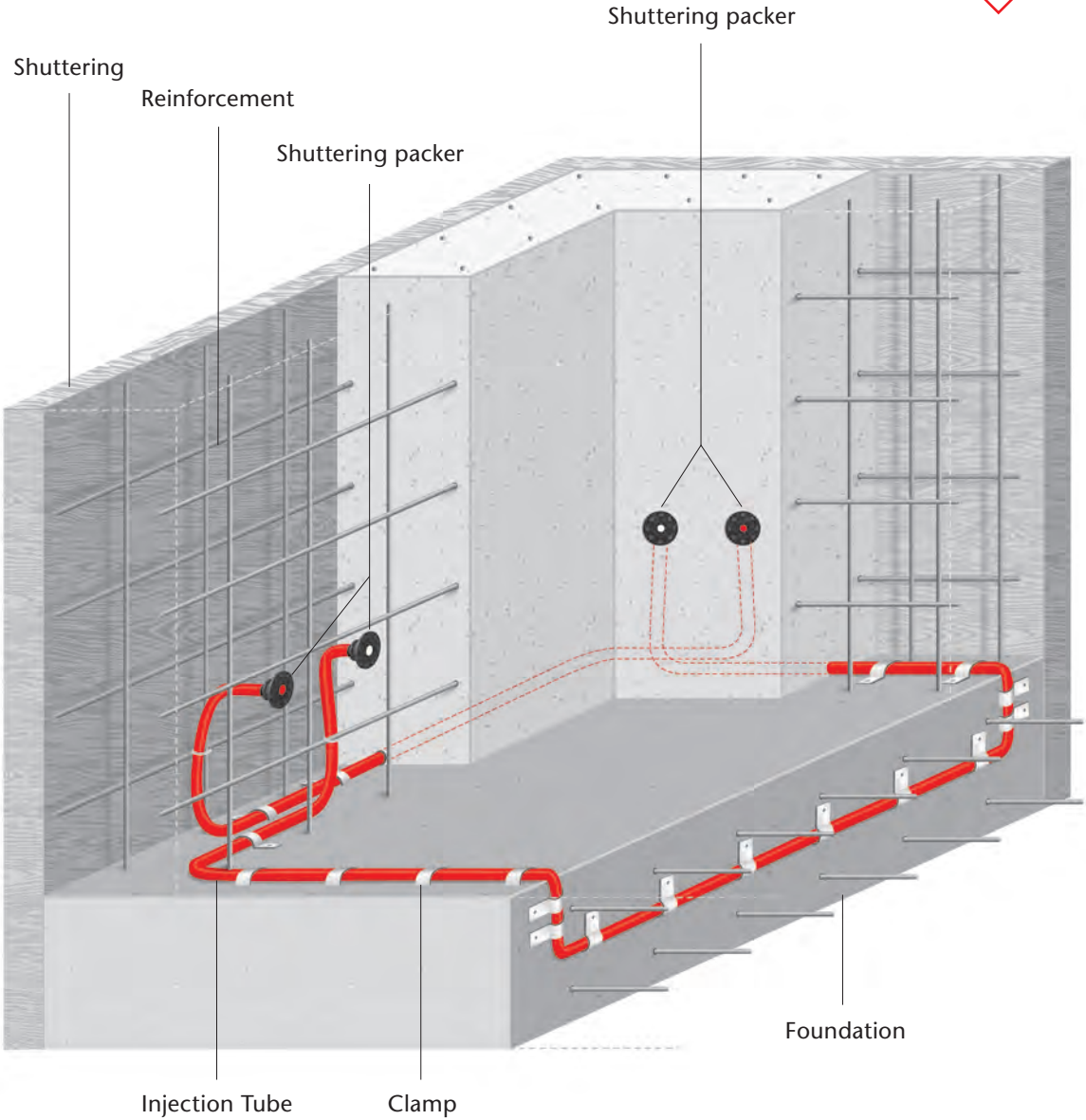

For further information
please refer to the instal-
lation manual of the
injection hose.

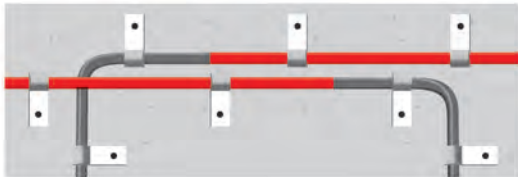

Swelling Tapes

WEBAC® Bentonite Swelling Tape

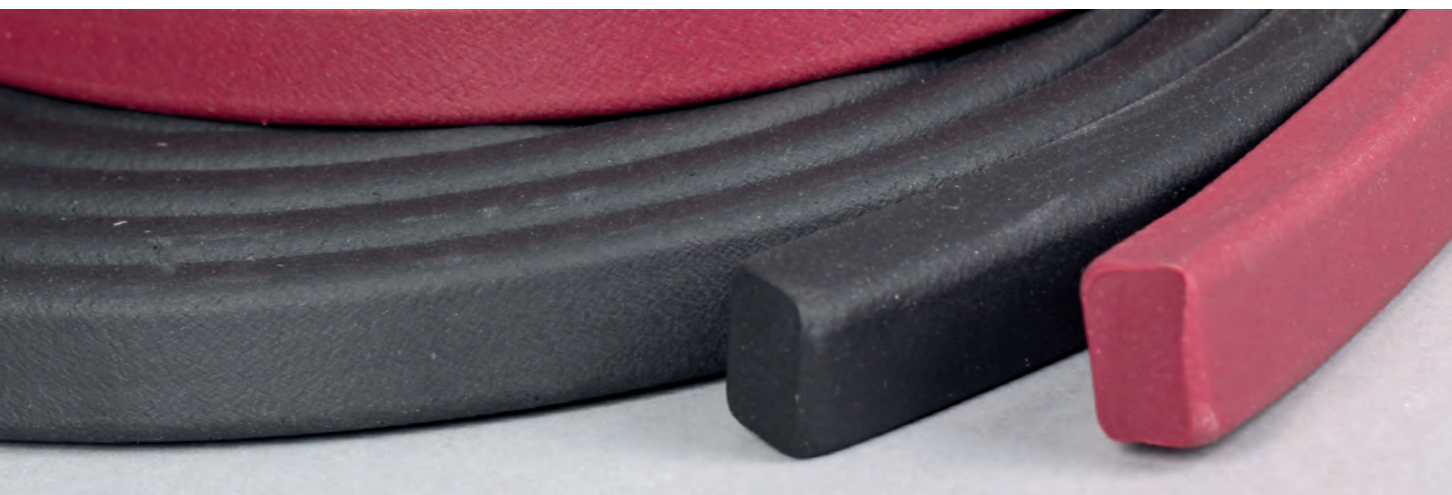

Range of application

- Sealing of construction joints against soil moisture, non-pressing and pressing water in concrete and reinforced concrete construction
- Sealing of pipe ducts

Special properties

- Reversible swelling behavior
- Self injecting properties
- No separation and thus no washing out from joints

Installation

- Installation with **WEBAC® Contact Adhesive**, fastening grid, mechanical fastening

Technical parameters

Profile shape: 20 x 25 mm

Water pressure: tested with 5 bar

Concrete cover: at least 8 cm

Tests: National Test Certificate by MPA-BS
Test Report: Immersion of WEBAC Swelling Tapes
in saline solutions of different concentration

Swelling Tapes

WEBAC® Polymer Swelling Tape

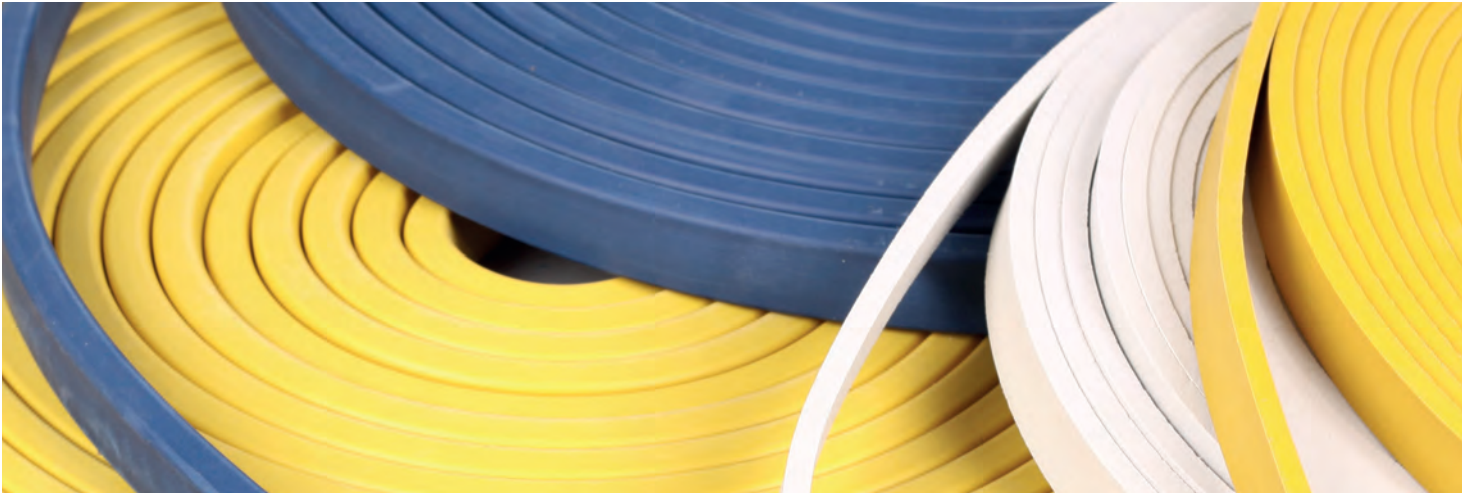

Range of application

- Sealing of construction joints against soil moisture, non-pressing and pressing water in concrete and reinforced concrete construction
- Sealing of joints in precast concrete unit construction, tubing construction
- Repair of expansion joints
- Sealing of pipe ducts

Special properties

- Reversible swelling behavior
- Permanent dimensional stability
- Excellent chemical resistance
- Flexible

Installation

- Installation with **WEBAC® Contact Adhesive**, mechanical fastening

Technical parameters

Profile shape:

20 x 5 mm, 20 x 10 mm, 20 x 20 mm, 30 x 30 mm

Water pressure: tested with 5 bar

Concrete cover: at least 8 cm

Tests: National Test Certificate by MPA-BS

Test Report: Immersion of WEBAC Swelling Tapes in saline solutions of different concentration

Accessories



WEBAC® Contact Adhesive

Range of application

- Bonding of WEBAC® Polymer Swelling Tape and WEBAC® Bentonite Swelling Tape

Special properties

- Flexible
- Fast curing
- Adhesion also to wet surfaces

Technical parameters

Density, 23 °C / 73 °F: $\approx 1.4 \text{ g/cm}^3$

Skin forming time at 50% air humidity,
23 °C / 73 °F: $\approx 5 \text{ min}$

Curing time at 3.5 mm layer thickness,
23 °C / 73 °F: $\approx 24 \text{ h}$

Application temperature
5 °C / 41 °F up to 40 °C / 104 °F

Tensile strength • elongation at break
 $\approx 3.0 \text{ N/mm}^2$ • $\approx 300\%$

E modulus: $\approx 1.6 \text{ N/mm}^2$

The specified data are values determined under laboratory conditions and are subject to a certain fluctuation. Deviations are possible in practice depending on the respective object situation.

WEBAC® Fastening Grid

Range of application

- Fastening of WEBAC® Bentonite Swelling Tape

Technical parameters

Shape: U shape

Length: 1 m

Installation

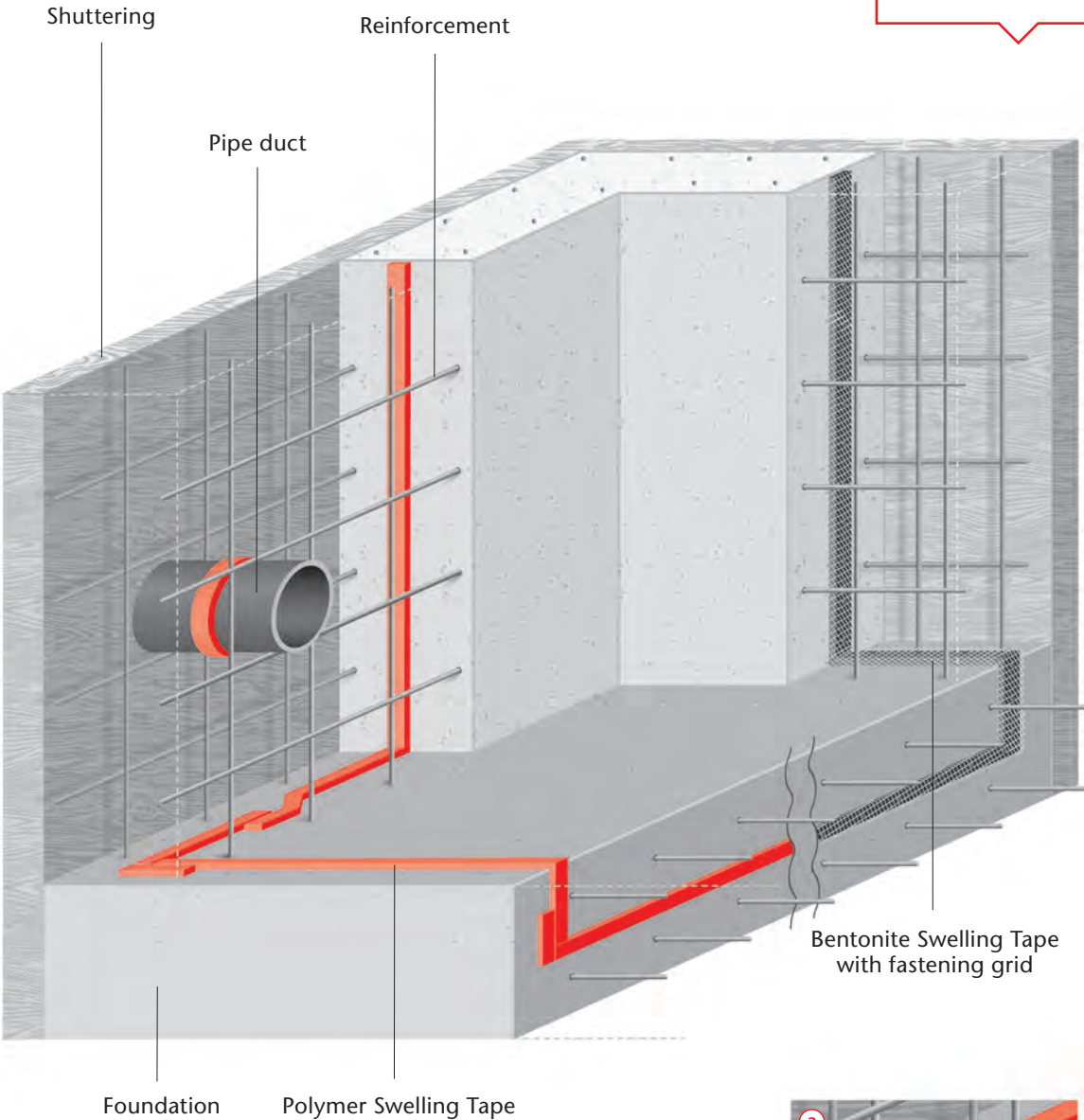

Installation of **WEBAC® Polymer Swelling Tape** with **WEBAC® Contact Adhesive**



Installation of **WEBAC® Bentonite Swelling Tape** with **WEBAC® Fastening Grid**, mechanical fastening

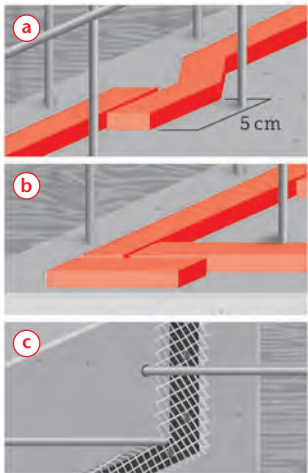

Variations of installation:

- (a) Overlapping connection
- (b) Horizontal corner connection (Polymer swelling tape)
- (c) Horizontal corner connection (Bentonite swelling tape)

Swelling Tapes

WEBAC® Swelling Paste



Range of application

- Sealing of construction joints, material transitions and other waterproofing-related details in concrete and reinforced concrete construction
- Fastening of WEBAC Swelling Tapes on concrete or various other substrates
- Reliable and easy sealing of intersections also in areas difficult to access

Special properties

- 1C PU, swellable
- Very high elongation
- Moisture-curing
- Easy to use also on uneven ground

Instruction for use

- Cartridge processing

Technical parameters

Density, 23 °C / 73 °F (ISO 2811): $\approx 1.4 \text{ g/m}^3$

Skin forming time at 50% air humidity,
23 °C / 73 °F: $\approx 120 \text{ min}$

Curing time at 1.5 mm layer thickness,
at 50% air humidity, 23 °C / 73 °F: $\approx 24 \text{ h}$

Application temperature
3 °C / 37 °F to 30 °C / 86 °F

Tensile strength • elongation at break (ISO 527)
 $\approx 1.0 \text{ N/mm}^2 \cdot \approx 1,000\%$

Swelling in water, 23 °C / 73 °F, > 14 d: $\approx 400\%$

The specified data are values determined under laboratory conditions and are subject to a certain fluctuation. Deviations are possible in practice depending on the respective object situation.

Tie Point Sealing

WEBAC® Plug/Ring/Flange



Range of application

- Sealing of intersections/tie points with swellable sealing rings and plugs in concrete and reinforced concrete construction
- Suitable for fiber reinforced concrete pipes, plastic pipe spacers, foundation earth electrodes

Special properties

- Easy and economical solution
- Sealing with a simple hammer blow
- No gluing
- Temperature- and weather-independent
- Active swelling sealant
- Also suitable in case of negative pressing water



Technical parameters

WEBAC® Plug

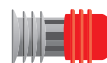

22, 24, 26 mm

WEBAC® Ring



24 mm

WEBAC® Flange



12, 17, 24, 31, 39 mm

Water pressure: tested with 5 bar

Tests: Test report by MPA-BS

The specified data are values determined under laboratory conditions and are subject to a certain fluctuation. Deviations are possible in practice depending on the respective object situation.

Injection Packers

WEBAC® Injection Packers



Range of application

Injection packers are filler necks used as connection pieces between the structural elements and the injection device during injection processes, e.g. when

- Sealing buildings
- Repairing cracks

Suitable for ...

- PU Injection Foam Resins
- PU Injection Resins
- Epoxy Injection Resins
- Acrylate Gels
- PU Casting Foam Resins
- Silicate Injection Grouts

Special properties

- Compatible with injection material
- Good fastening in the building structure
- Corrosion resistance
- High pressure resistance
- Shutoff device towards the building structure
- Available with zerk head/button head fitting and high-pressure or low-pressure fitting



Drill hole packers

WEBAC® Mechanical Packer Type S

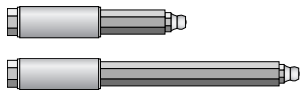

- Easy to handle
- Economical use
- For normal injection processes

WEBAC® Mechanical Packer Type R

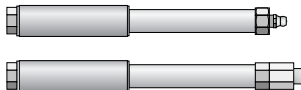

- Versatile use
- Can also be equipped with button-head fittings for higher flow rates

WEBAC® Hammer-in Packers

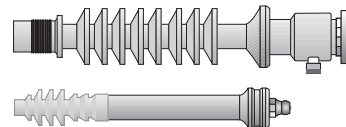

- Easy to handle
- Not suitable for porous masonry/concrete

Surface packers

WEBAC® Surface Packer aluminum



- No drilling required (non-destructive injection)
- Often used on horizontal surfaces

WEBAC® Surface Packer plastic

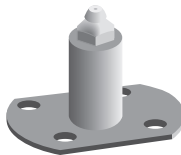

- No drilling required (non-destructive injection)
- Often used on horizontal surfaces

One-day packer

WEBAC® One-day Packer



- No material reflow from the packer due to non-return valve
- Dismantling and closing possible immediately after the injection
- All operations can be carried out on the same day

WEBAC® Sealing Tape XT



Range of application

- Sealing of construction joints and predetermined breaking points in cast-in-situ concrete resistant to hydrostatic pressure
- Sealing of precast concrete units and precast walls

Special properties

- Exterior sealing system in strip form
- Permanently elastic and aging resistant

Installation

- Gluing with **WEBAC® 4530/4535**

Technical parameters

Total thickness

Var. I $\approx 1.0 \text{ mm} \pm 0.1 \text{ mm}$

Var. II $\approx 2.0 \text{ mm} \pm 0.1 \text{ mm}$

Total width

200 mm $\pm 2 \text{ mm}$

Coating width

75 mm each on both sides

Total weight

I $\approx 930 \text{ g/m}^2 \pm 50 \text{ g/m}^2$

II $\approx 1,830 \text{ g/m}^2 \pm 100 \text{ g/m}^2$

Breaking elongation

longitudinal: **I** $\approx 15 \text{ N/mm}^2$

II $\approx 10 \text{ N/mm}^2$

transversal: **I** $\approx 15 \text{ N/mm}^2$

II $\approx 10 \text{ N/mm}^2$

Maximum tensile force

longitudinal: **I** $\approx 620\%$

II $\approx 680\%$

transversal: **I** $\approx 670\%$

II $\approx 710\%$

Bursting pressure max.

I $\geq 4,0 \text{ bar}$

II $\geq 5,0 \text{ bar}$

Shore hardness A: ≈ 87

Adhesive strength: $\geq 40 \text{ N/mm}^2$

Chemical resistance acc. to ZDB bulletin: fulfilled

UV resistance: fulfilled

Temperature resistance

$-30 \text{ }^\circ\text{C} / -22 \text{ }^\circ\text{F}$ up to $+90 \text{ }^\circ\text{C} / 194 \text{ }^\circ\text{F}$

The specified data are values determined under laboratory conditions and are subject to a certain fluctuation. Deviations are possible in practice depending on the respective object situation.

Installation

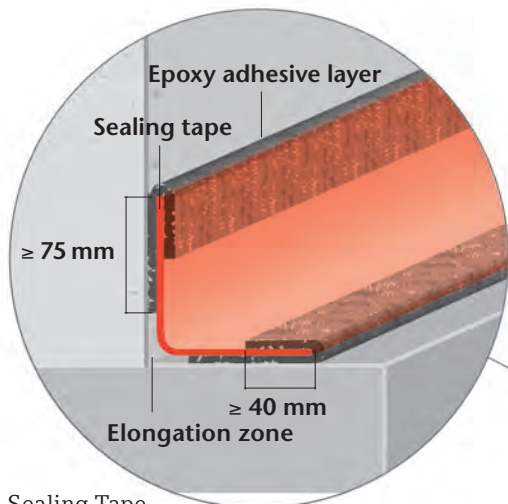

Sealing Tape
Floor-wall-connection

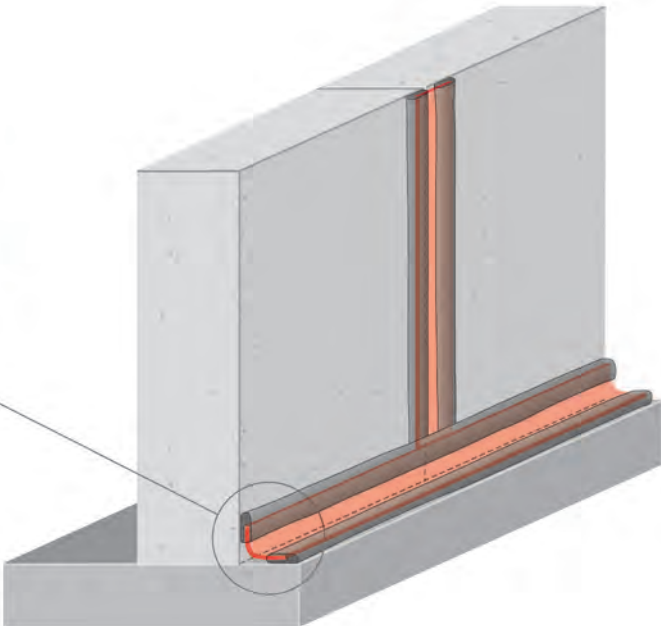

Welding of overlap

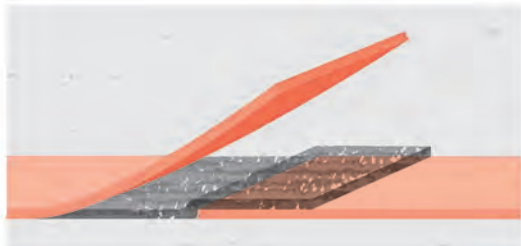

Bonding of overlap

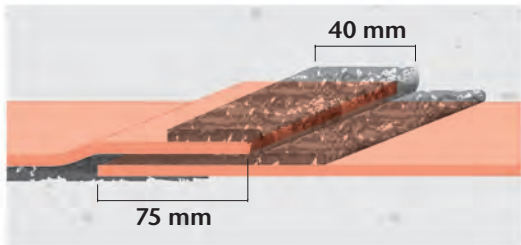

Reworking to overlap joint

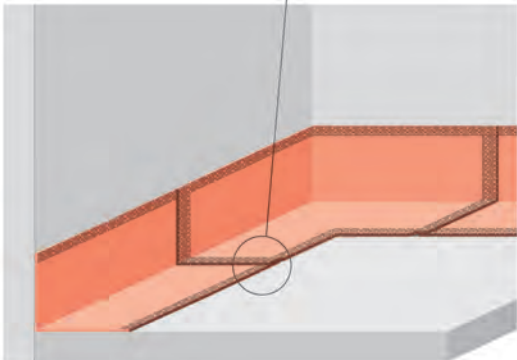
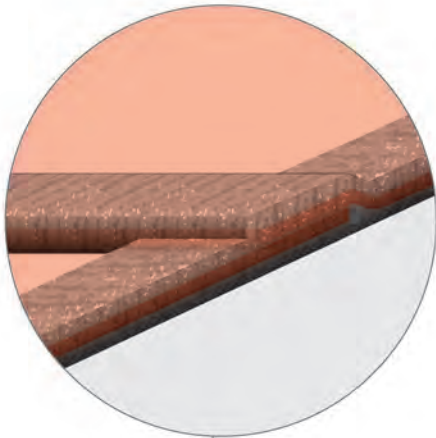

Installation of the sealing systems

WEBAC® Impact Profiles EPDM



Range of application

- Sealing of structural elements joints and movement joints
- Suitable as end profile for joints

Special properties

- Heat resistance
- Workability also at low temperatures
- Weathering, chemical, UV and ozone resistance

Installation

- Manually or mechanically with a special chisel hammer
- The profile size should exceed the joint width by approx. 30%

Technical parameters

Profile shape: Ø 20 mm, Ø 25 mm, Ø 30 mm, Ø 35 mm, Ø 40 mm, Ø 45 mm, Ø 50 mm

Density: $\approx 0.55 \text{ g/cm}^3$

Tensile strength: $\geq 3 \text{ N/mm}^2$

Elongation at break: $\geq 150\%$

Shore hardness A: $\approx 20 \pm 5$

Surface texture: even

Color: grey black

The specified data are values determined under laboratory conditions and are subject to a certain fluctuation. Deviations are possible in practice depending on the respective object situation.

WEBAC® Compression Profiles

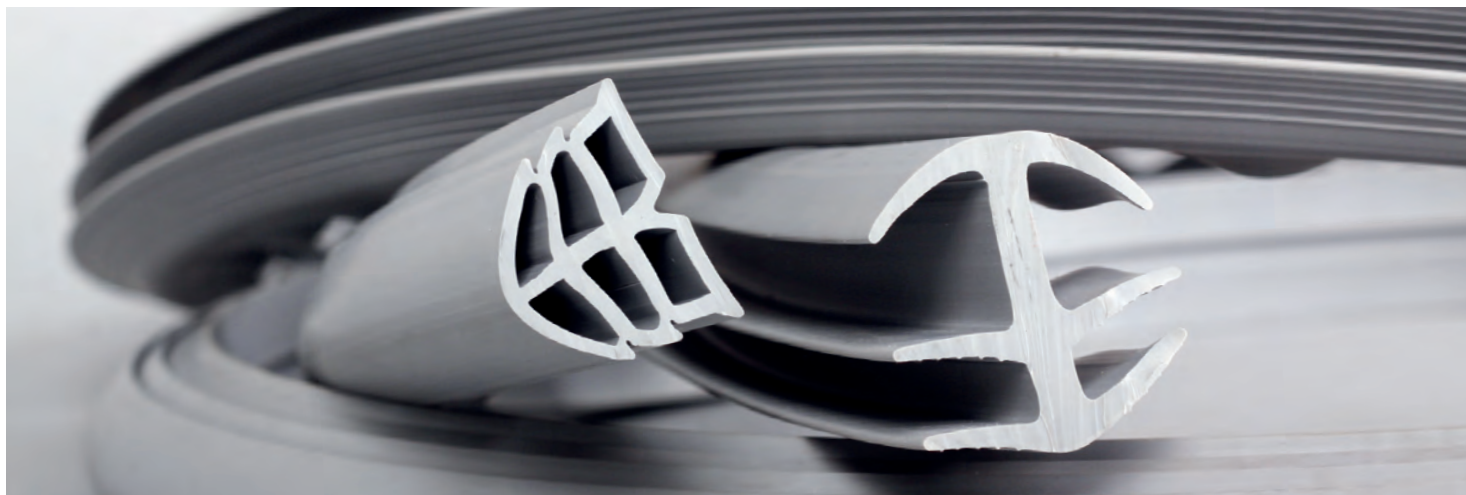

Range of application

- Sealing of structural joints and movement joints
- Suitable as end profile for joints

Special properties

- TPE:
 - Also flexible at low temperatures
 - Aging resistant
 - UV-resistant
 - High elongation at break
- Nitriflex:
 - Chemical resistance
 - Aging resistant
 - Permanently elastic
 - High breaking elongation

Installation

- Manually or mechanically with a special chisel hammer

Profile width	Joint width
---------------	-------------

Profile 1 (optional Nitriflex or TPE) in mm

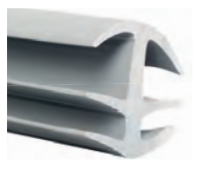
	25	14–16
	35	20–24
	50	26–33

Profile 2 (optional Nitriflex or TPE) in mm

	20	13–16
	30	19–23
	40	29–33

Further sizes on request.

Information & Service

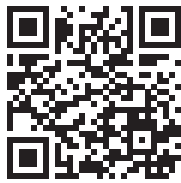
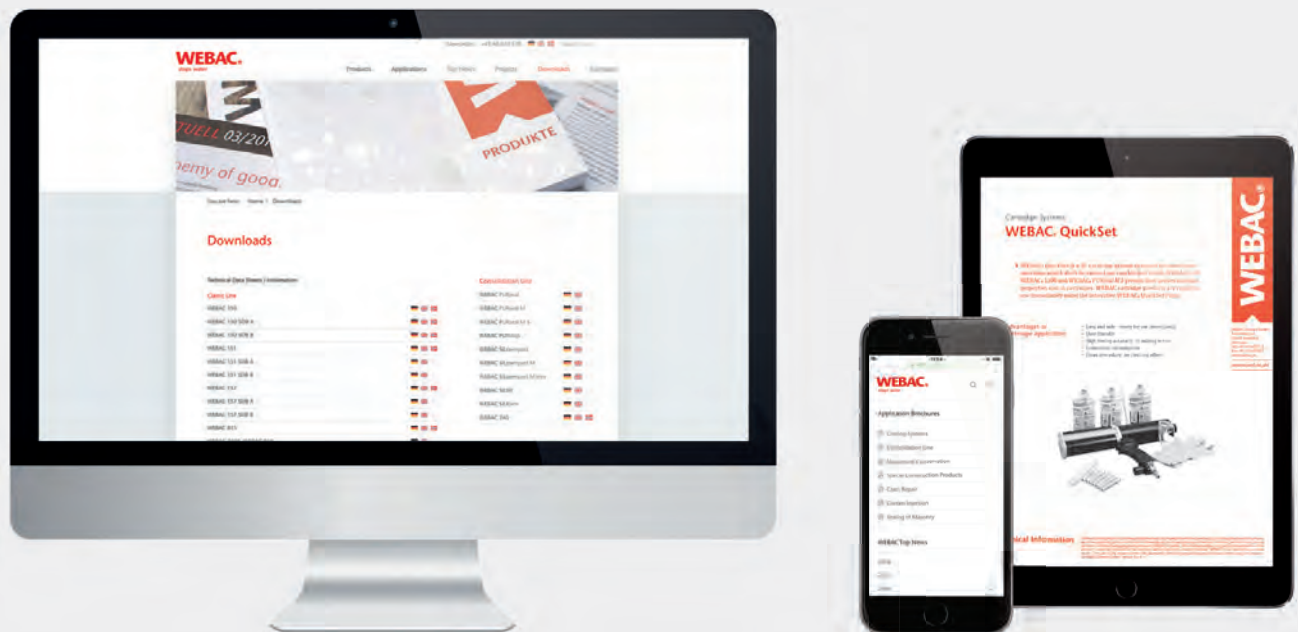

webac-grouts.com

In the **download area** of **www.webac-grouts.com** you will find further information and technical data sheets of our products and application brochures.

Any questions? Don't hesitate to contact us!
Tel. +49 40 67057-0



WEBAC®

WEBAC-Chemie GmbH

Fahrenberg 22

22885 Barsbüttel/Hamburg, Germany

Tel. +49 40 67057-0 · Fax +49 40 6703227

info@webac.de · www.webac.de

www.webac-grouts.com



We are an associate
member in DBV



Responsible-Care

WMA

STUVA

BuFAS

DEUTSCHE
BAUCHEMIE