

## Injection Packers

# WEBAC® Injection Packers

- Injection packers are used as connecting pieces between the structural element and the injection device. Depending on the required pressure, the nature of the structural element and the injection material, different versions of packers are available.

### Range of application

- Sealing of buildings
- Crack repair
- Stabilization of structures
- Soil solidification

### Suitable for

- PU injection foam resins
- PU combi injection resins
- PU injection resins
- PU casting foam resins
- Acrylate gels
- Silicate injection solutions
- Epoxy injection resins

### Properties

- Compatible with injection material
- Good fastening in the building structure
- Corrosion resistance
- High pressure resistance
- Shutoff device towards the building structure
- Available with zerk head/button head fitting and high-pressure or low-pressure fitting

### Examples

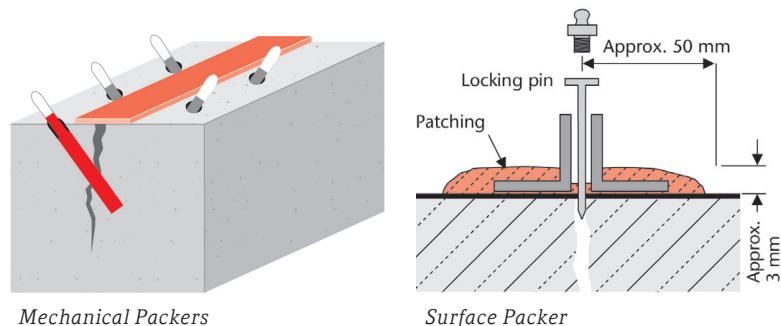

WEBAC-Chemie GmbH  
Fahrenberg 22  
22885 Barsbüttel  
Germany  
Tel. +49 40 67057-0  
Fax +49 40 6703227  
info@webac.de

[www.webac.de](http://www.webac.de)

## Technical Information

All the data indicated in this technical data sheet and any related information provided by our employees are of an advisory nature representing our current state of knowledge and in no way binding. As the exact chemical, technical and physical conditions of the actual application are beyond WEBAC's control, this information does not preclude examination of the products and/or procedures for the intended application and surface by the user. WEBAC is thus unable to guarantee results. The user is fully responsible for the observation of existing regulations and conditions when using the products.  
© WEBAC-Chemie GmbH. Version 03/2020

## Injection Packers

# WEBAC® Injection Packers

### Drill hole packers

#### WEBAC® Mechanical Packer Type S

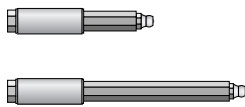

- Easy to handle
- Economical use

#### WEBAC® Mechanical Packer Type R

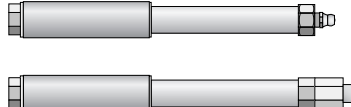

- Versatile use
- Can also be equipped with button-head fittings for higher delivery rates

#### WEBAC® Hammer-in Packer

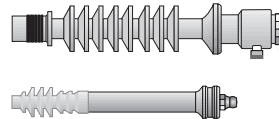

- Easy to handle
- **Note:** not suitable for porous masonry/concrete

### Surface packer

#### WEBAC® Surface Packer plastic

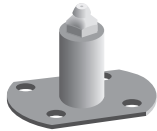

- High-pressure
- No drilling required (non-destructive injection)
- Often used on horizontal surfaces

### Drill hole packer

#### WEBAC® One-Day Packer Type S



- No material reflow from the packer due to non-return valve
- Dismantling and closing possible immediately after the injection
- All operations can be carried out on the same day

## Injection Packers

# WEBAC® Injection Packers

### Installation

- The size of the drill holes depends on the conditions on site and the packers used:
  - When using mechanical packers, the drill holes should usually be 1 mm larger than the diameter of the packers
  - When using hammer-in packers, the recommended drill hole size corresponds to the diameter of the packers
- Drill holes are generally made slanting downwards at an angle of approx. 30° – 45° depending on the wall thickness
- ▶ See **WEBAC Brochures Sealing of Masonry, Crack Repair and Curtain Injection**



Sealing of Masonry



Crack Repair



Curtain Injection

### Final work

- Dismount the drill hole packers/surface packers
- Knock off the hammer-in packers and, if applicable, remove the patching

### Cleaning

- **WEBAC® Mechanical Packers Type R** can be rinsed with the flushing pump after application of injection gels

### Storage

- Protect from moisture and mechanical damage

## ▶ Technical Information

All the data indicated in this technical data sheet and any related information provided by our employees are of an advisory nature representing our current state of knowledge and in no way binding. As the exact chemical, technical and physical conditions of the actual application are beyond WEBAC's control, this information does not preclude examination of the products and/or procedures for the intended application and surface by the user. WEBAC is thus unable to guarantee results. The user is fully responsible for the observation of existing regulations and conditions when using the products.  
© WEBAC-Chemie GmbH. Version 03/2020

## Injection Packers

# WEBAC® Injection Packers

### Examples for positioning of drill holes

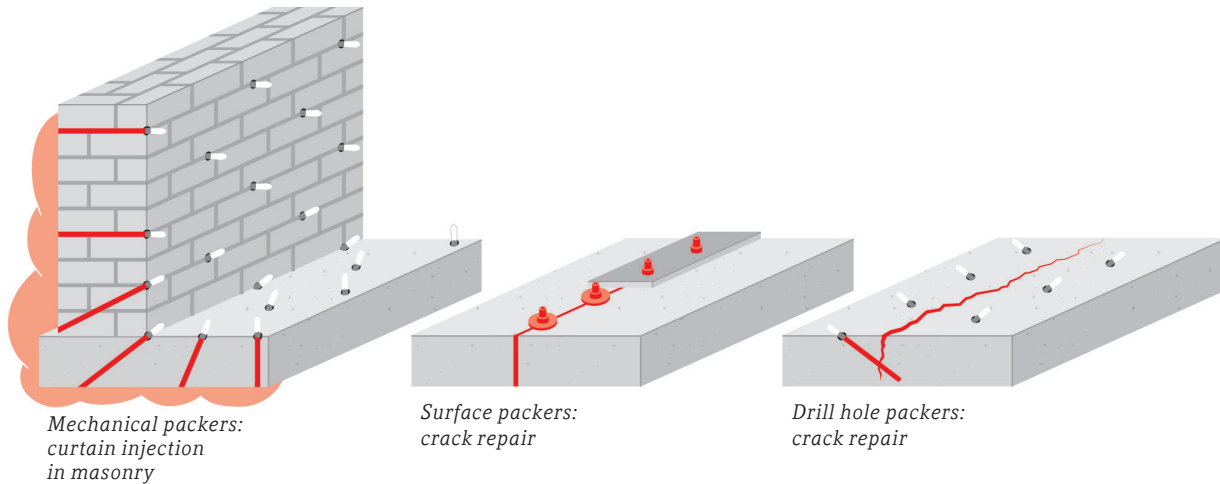

WEBAC-Chemie GmbH  
Fahrenberg 22  
22885 Barsbüttel  
Germany  
Tel. +49 40 67057-0  
Fax +49 40 6703227  
info@webac.de

[www.webac.de](http://www.webac.de)

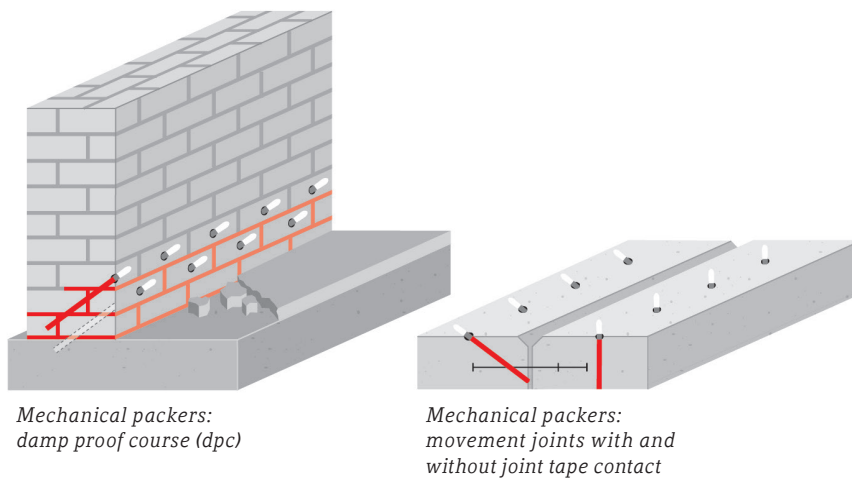

### Occupational safety/waste disposal

► Downloads on [webac-grouts.com](http://webac-grouts.com)



[webac-grouts.com/  
downloads](http://webac-grouts.com/downloads)

## Technical Information

All the data indicated in this technical data sheet and any related information provided by our employees are of an advisory nature representing our current state of knowledge and in no way binding. As the exact chemical, technical and physical conditions of the actual application are beyond WEBAC's control, this information does not preclude examination of the products and/or procedures for the intended application and surface by the user. WEBAC is thus unable to guarantee results. The user is fully responsible for the observation of existing regulations and conditions when using the products.  
© WEBAC-Chemie GmbH. Version 03/2020